

111

Economy-US-Type with stamped Contacts D-Subminiatur Connector with Dip-Solder Contact 90°R.A.

Technical data

Material shell: steel , nickel plating
 Insulator: Thermoplastic polyester
 Burning properties: self-extinguishing rated 94V-0
 Contact: Cooper alloy
 Contact surface: gold plated over nickel
 Operating Temperature: -55°C to +105°C
 Electrical data :
 Current rating : 5A
 Working voltage: 125VAC
 Test voltage: 1000V/50hz
 Contact resistance : 10mOhm
 Insulator resistance: 10¹⁰Ohm min. 500VDC
 Mating cycles: Class 3=min. 50cycles



Female

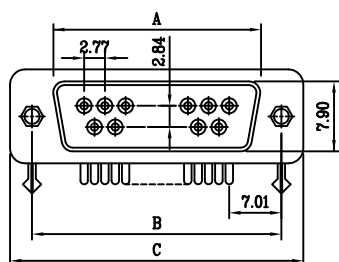

Male

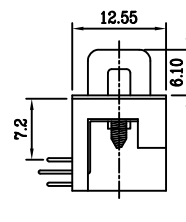
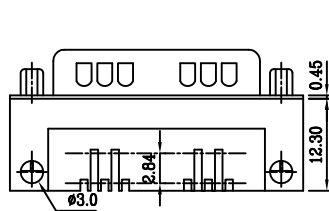
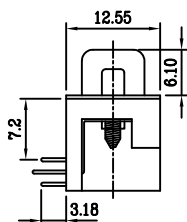
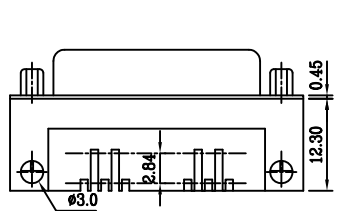
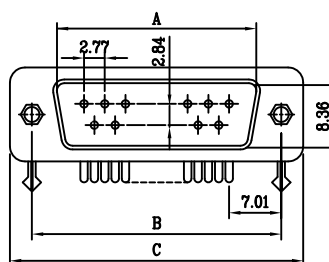

How to order - - - - - - -

Serie-Nr.

Nr. of Contact

Terminal Type

Mounting option

Hexagonal Bolt

Plating

Material option

Nr. of contact	code
09	09
15	15
25	25
37	37

Terminal type	Code
Plug	1
Socket	2

	Dimensions(Male version)		
	A	B	C
9	16.92	24.99	30.81
15	25.25	33.32	39.14
25	38.96	47.04	53.04
37	55.42	63.50	69.32

	Dimensions(Female version)		
	A	B	C
9	16.33	24.99	30.81
15	24.66	33.32	39.14
25	38.38	47.04	53.04
37	54.84	63.50	69.32

Mounting method	Code
4#40 Thread rivet W/Boardlock	10
Non rivet,Fixed screws W/Boardlock	20
Non thread rivet	30
4#40 Thread rivet only	31
4#40 Thread rivet W/L bracket	40
Non rivet,Fixed screws W/L Bracket	50
4#40 Thread rivet W/4-prong boardlock	60
M3 Thread rivet W/ bracket	70
M3 Thread rivet W/L Boardlock	80
M3 Thread rivet W/4-prong boardlock	90

Plating Option	Code
Full gold Flash plating	10
Selective gold flash plating	60
5u" selective gold plating	05
15u" selective gold plating	15
30u" selective gold plating	30

Hexagonal bolt Option	Code
Loose HEX.Screws 4.8x11.8	10
Fixed HEX.Screws 4.8x11.8	20
Loose HEX.Screws 5.8x12.0	30
Fixed HEX.Screws 5.8x12.0	40
NON-Accessories	50

Material option	Code
Bronze	1
Phosphor bronze	2

W.E.