

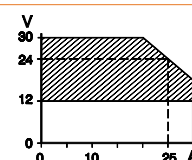

600 S - Series 600 W SWITCHED MODE DC POWER SUPPLY

Models	Voltage range	Current range
600 S 24	12 -15 V	30 A
	24 V	25 A
	30 V	20 A



Features :

- Very high reliability, MTBF 1.000.000 hrs
- Natural convection cooling
- Thermally over-rated for high ambient temperature without derating
- Build-in diode for redundant parallel operating
- Under-voltage alarm contact
- Low output ripple, 7 mV rms
- No RFI problems, RFI filters in output and input
- Meets EN 61000-3-2 and V DE 0160 class 2
- Low inrush current
- High efficiency 89%
- Short circuit protected
- Analog programmable

Specifications :

- Input voltage : AC 198-264 V 48-62 Hz 3.8 Arms
fuse 6.3 A T, crest factor 2.0
: AC 99-132 V 48-62 Hz 7.6 Arms
fuse 12.5 A T
: DC contact factory
- Insulation : 3750 V rms (1min)
- Input / output : 2500 V rms (1min)
- Input / case : 500 V DC
- Output / case : 500 V DC
- Inrush current : Limited by 47 Ohm (shorted after startup)
- Power factor : 0.76 at 230 V AC input and full load.
- EMC : EN 61204-3 Power Supply Standard
: EN 61000-6-3 Emission (EN 55022B)
: EN 61000-6-2 Immunity
- VDE0160 impulse test : Input with stands non periodic impulse
2.3 \hat{U}_N 1.3 ms of VDE0160 class 2
- Line distortion : Harmonic current meets EN 61000-3-2
- Safety : EN 60950, EN 61010 SELV / PELV
- Output voltage : Screwdriver adjustable with 10-turn
potmeter at the rear side.
Factory set at 24.0 V
Also analog programmable by 2-5 V
- Efficiency : 89% at 230 V AC input and 600 W output
(max. heat dissipation 74 W)
- Temp. coeff : 5.10⁻⁵ per °C
- Stability : 3.10⁻⁴ during, 8 hrs under constant
conditions, after 1 hr warmup.
- Regulation
Load 0 - 100% : Better than 10 mV
line 198-264 V : Better than 5 mV
- Ripple + noise : Max 7 mV rms, 20 mV pp (BW = 20 MHz)
- Output imp. : Less than 0.05 Ohm up to 100 kHz
- Recovery time : 0.3 milliseconds to recover to within
100 mV after a 50 to 100% load step
Max. deviation 300 mV
- Hold-up time : 30 ms at 155 or 230 V AC input and full
load. 60 ms at half load.
- Series operations : up to 500 V total voltage
- Parallel oper. : No restrictions
- Redundant parallel operation : Use R+ connection via build-in Schottky
diode to separate the outputs. Do not use
remote sensing.

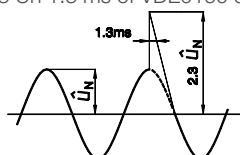

- Under voltage alarm contact : Changes over when output voltage drops to 10% below the the set value.
Gold contact, rating 100 mA/30 V.
- Remote control : Is possible with a 10 k Ω potmeter.
- Remote programming : Output voltage is programmable with 2-5 V, corresponding with 12-30 V. Programming speed is 100 ms from 12-30 V at max current. Programming input is not isolated (connected to - output).
- Remote sensing : max. 3 V per load lead. However the sum of the voltage across load + leads cannot exceed 30 V.
With parallel operation remote sensing is not recommended.
- Remote on/off : By 5 V, optocoupler isolated.
- Ambient temperature
Storage : -40 to + 85 °C
Operating : -20 to + 60 °C
Derate to 20% at 75 °C

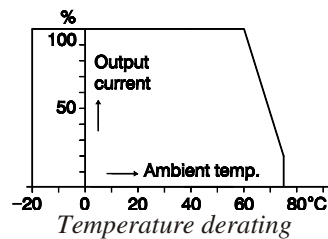

- Overload Protection: Continuous overload and short circuit protection does not harm the unit. At short circuit the power supply produces an audible bleep.
- Voltage limit : For safety an extra regulation circuit limits the output voltage to about 31 V in case of malfunction of the normal regulation. This limit is internally adjustable 20-31 V (R111).
- Overtemp. protection : With insufficient cooling the shuts down.
- Led lamps : Green LEDs on front and rear panel indicate output voltage.
- Wall mounting : Any position, as long as the air can flow freely along the unit for cooling.

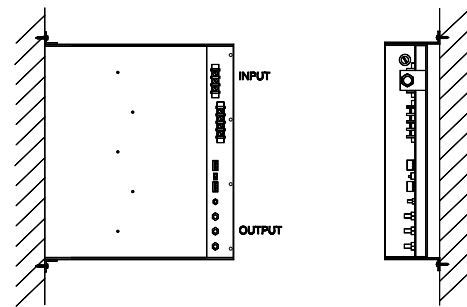

Two ways of vertical mounting

- Current limit : From 30 to 18 V the current limit follows more or less a constant power curve. Below 18 V it resembles a constant current curve.

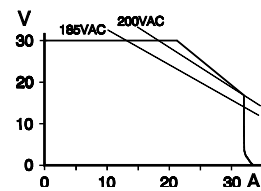

Normal current limit and derating at low input voltage.

- 19" rack mounting : With two brackets H88 with handle the unit can be 19" rack mounted (2U height)
- MTBF : 1.000.000 hrs
- Dim and weight : Height 88mm
Width 433mm
Depth 385mm
Weight 10.5 kg

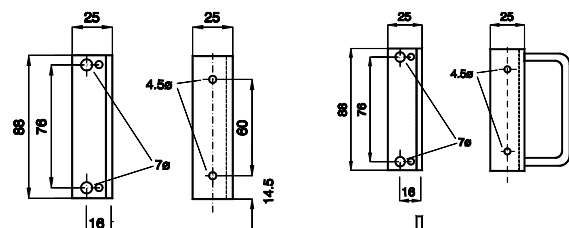
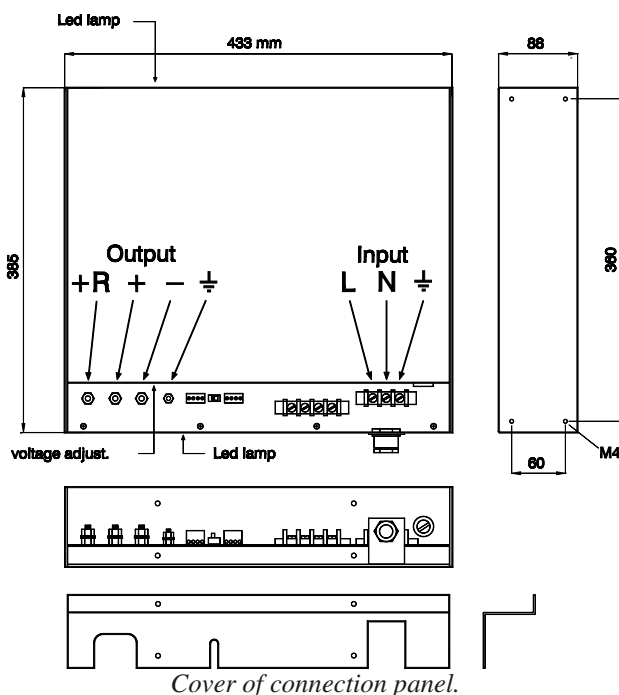

Bracket H88 for vertical wall mounting (2 pcs required)

Bracket H88 with handle for 19" rack mounting (2 pcs required)

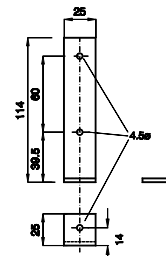

Bracket H114 for vertical wall mounting. (4 pcs required)