

.25"(6.35mm) Pitch Power Connectors

63501TM Male Crimp Terminal

63501TM : Used in 63501H-N series housing
(1 ~ 5 circuits)

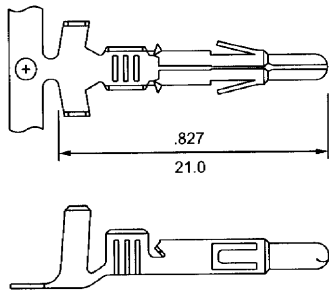

63501TF Female Crimp Terminal

inches
mm

63501TF : Used in 63501H-N series housing
(1 ~ 15 circuits)

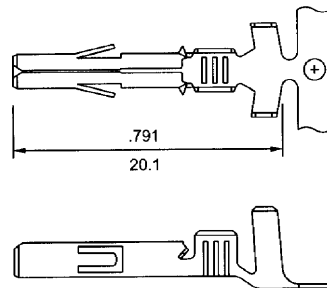

63501TMD : Used in 63501H-N series housing
(6 ~ 15 circuits)

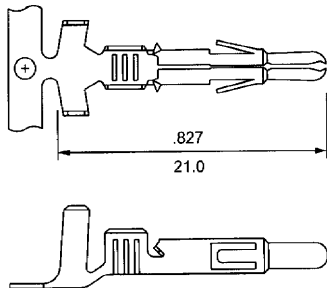

Ordering Information

Part No.	Material	Finished	Thickness	Wire range
63501TM1	Brass	Tin-plated	0.3mm	#18 ~ #22
63501TM2				#16 ~ #20
63501TM3				#12 ~ #14
63501TMD1				#18 ~ #22
63501TMD2				#16 ~ #20
63501TMD3				#12 ~ #14
63501TF1				#18 ~ #22
63501TF2				#16 ~ #20
63501TF3				#12 ~ #14

63501H-N Series

Features/Dimensions:

- Integrally molded polarization
- 94V-2 nylon 66
- Accept 63501T.25"(6.35mm) crimp type terminals
- 1, 2, 3, 4, 5, 6, 8, 9, 10, 12, 15 circuits available
- Friction lock
- Standard color: Nature

Circuits	Dimensional Information	
	Plug	Receptacle
1	<p>63501HF-01</p> <p>inches mm</p>	<p>63501HM-01</p> <p>inches mm</p>

.250"(6.35mm) Pitch Power Connectors

Circuits	Dimensional Information			
	Plug		Receptacle	
2	63501HF-02 		63501HM-02 	
3	63501HF-03 		63501HM-03 	
4	63501HF-04 		63501HM-04 	

.250" (6.35mm) Pitch Power Connectors

Circuits	Dimensional Information	
	Plug	Receptacle
5	<p>63501HF-05</p>	<p>63501HM-05</p>
	<p>63501HF-06-S</p>	<p>63501HM-06-S</p>
6	<p>63501HF-06</p>	<p>63501HM-06</p>

.250"(6.35mm) Pitch Power Connectors

Circuits	Dimensional Information			
	Plug		Receptacle	
7	63501HF-07 		63501HM-07 	
	63501HF-08 		63501HM-08 	

.250"(6.35mm) Pitch Power Connectors

Circuits	Dimensional Information	
	Plug	Receptacle
9	<p>63501HF-09-S</p> <p>Dimensions: 2.299 (58.4) height, 1.079 (27.4) width, .300 (7.62) pitch.</p>	<p>63501HM-09-S</p> <p>Dimensions: 2.299 (58.4) height, 1.079 (27.4) width, .300 (7.62) pitch.</p>
	<p>63501HF-09</p> <p>Dimensions: 1.079 (27.4) width, 1.130 (28.7) top width, .807 (20.5) top height.</p>	<p>63501HM-09</p> <p>Dimensions: 1.102 (28.0) width, 1.091 (27.7) top width, .807 (20.5) top height.</p>

.250" (6.35mm) Pitch Power Connectors

Circuits	Dimensional Information	
	Plug	Receptacle
10	63501HF-10 	63501HM-10
	63501HF-12 	63501HM-12

.250"(6.35mm) Pitch Power Connectors

Circuits	Dimensional Information	
	Plug	Receptacle
15	63501HF-15 	63501HM-15

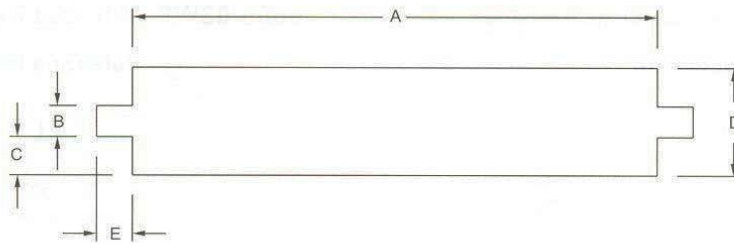

Recommended Panel Dim.

Dimensional Information - in (mm)

Circuits	Dim. A	Dim. B	Dim. C	Dim. D	Dim. E
2	0.565 (14.35)	0.340 (8.64)	0.095 (2.41)	0.530 (13.46)	0.175 (4.45)
3	0.815 (20.70)				
4	1.065 (27.05)				
5	1.315 (33.40)	0.154 (3.90)	0.189 (4.80)	0.531 (13.50)	0.126 (3.20)
6-s	1.567 (39.80)				
6	0.565 (14.35)				
7	1.817 (46.15)	0.480 (12.20)	0.275 (6.98)	1.030 (26.16)	0.175 (4.45)
8	2.067 (52.50)				
9-s	2.317 (58.85)				
9	0.815 (20.70)	0.154 (3.90)	0.189 (4.80)	0.531 (13.50)	0.126 (3.20)
10	2.567 (65.20)				
12	1.065 (27.05)				
15	1.315 (33.40)	0.480 (12.20)	0.275 (6.98)	1.030 (26.16)	0.175 (4.45)

&& Recommended panel thickness: .03" ~ .09"(0.762 ~ 2.286mm)
 Panel must be punched so that housing enters panel in same direction as the punch.