

RECOMMENDED P.C.BOARD HOLE DIMM.

SPECIFICATIONS

Electrical

Current Rating: 5A AC, DC

Voltage Rating: 250V AC, DC

Operating Temp.: $-25^{\circ}\text{C} \sim +85^{\circ}\text{C}$

Insulation Resistance: $1000\text{M}\Omega/\text{min.}$

Dielectric Withstanding Voltage: $1500\text{V AC}/\text{min.}$

Contact Resistance: $10\text{m}\Omega/\text{max.}$

Material

Material: Nylon66, UL94V-2.

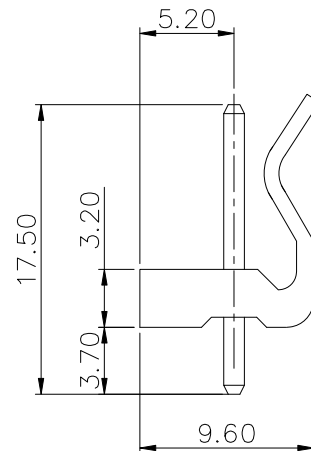
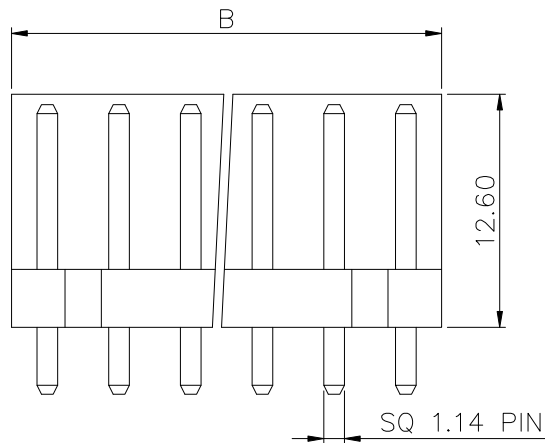

Poles	Dimension(mm)		Part No.	Note.
	A	B		
02	3.96	7.92	CW-W396-02	
03	7.92	11.88	CW-W396-03	
04	11.88	15.84	CW-W396-04	
05	15.84	19.80	CW-W396-05	
06	19.80	23.76	CW-W396-06	
07	23.76	27.72	CW-W396-07	
08	27.72	31.86	CW-W396-08	
09	31.86	35.64	CW-W396-09	
10	35.64	39.60	CW-W396-10	
11	39.60	43.56	CW-W396-11	
12	43.56	47.52	CW-W396-12	