

P.C.B LAYOUT

SPECIFICATIONS

Current rating	: 5A AC, DC
Voltage rating	: 250V AC, DC
Temperature range	: -25° C ~ +105° C
Contact resistance	: 10m OHM Max
Insulation resistance	: 1000M OHM Min
Withstanding voltage	: 1500 V AC/minute
Finished	: Brass/Tin-plated
Housing Material	: LCP, UL94V-0
Color	: Black

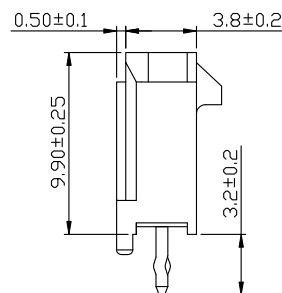
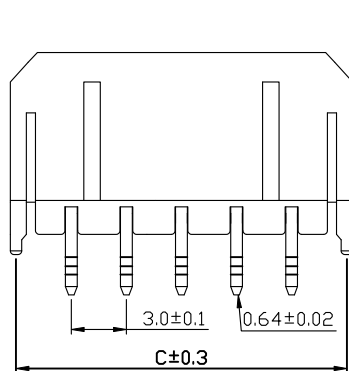

Part No.	Dimensions		
	A	B	C
CMF-W300-1X01C-CF438	6.85	----	6.00
CMF-W300-1X02C-CF438	9.85	3.00	9.00
CMF-W300-1X03C-CF438	12.85	6.00	12.00
CMF-W300-1X04C-CF438	15.85	9.00	15.00
CMF-W300-1X05C-CF438	18.85	12.00	18.00
CMF-W300-1X06C-CF438	21.85	15.00	21.00
CMF-W300-1X07C-CF438	24.85	18.00	24.00
CMF-W300-1X08C-CF438	27.85	21.00	27.00
CMF-W300-1X09C-CF438	30.85	24.00	30.00
CMF-W300-1X10C-CF438	33.85	27.00	33.00
CMF-W300-1X11C-CF438	36.85	30.00	36.00
CMF-W300-1X12C-CF438	39.85	33.00	39.00



DESCRIPTION(内容):
MX3.00mm Micro-Fit 180° 打K
(RoHS)

PART NO:
(料 號) CMF-W300-1xXXC-CF438

DWG NO(圖號):

DRAWN(製圖):
黃炳秋

CHECKED(確認):
黃炳秋

APPROVAL(核准):
邓文广

GENERAL TOLERANCE:
(公差)

XX ±0.40
X ±0.30
X ±0.20
XX ±0.15

XX' ±2'
XX' ±1'

SCALE(比例):
1:XX



REV:
A/1

UNIT:
mm

SIZE:
A4

SHEET:
1/1

REV

1

2

3

4

DESCRIPTION

DATE

2017.07.27