

Material and Finish

1. Housing: Thermoplastic (UL94V-0), Black.
2. Terminal: Sq. 0.64mm Copper Alloy, Gold Plating.

Electrical Characteristics

1. Current Rating: 3.0 Amp. Max..
2. Dielectric Withstand Voltage: 1000V AC RMS for 60Seconds.
3. Insulation Resistance: 1000M Ohms Min. at 1000V DC.

Mechanical Characteristics

1. Operating Temperature: -55°C ~ +105°C

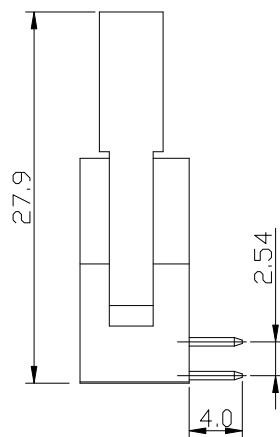
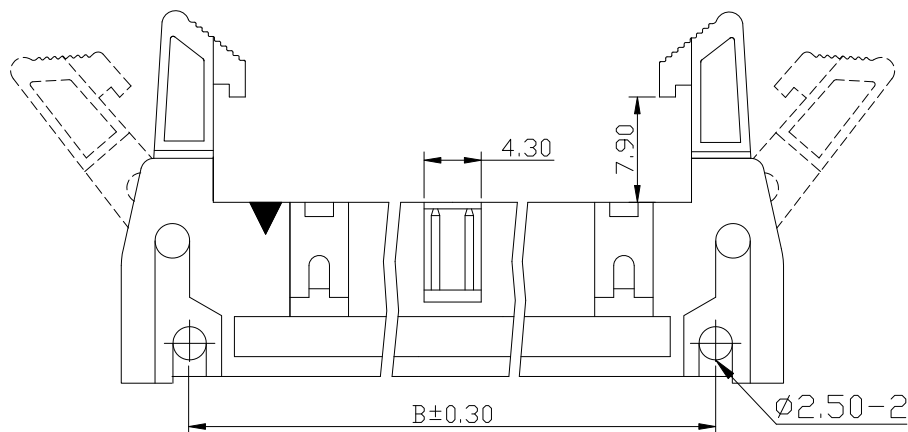

PART NO.	Dimensions			
	Pos.	A	B	C
CHE254R010	10	32.00	21.84	10.16
CHE254R012	12	34.54	24.38	12.70
CHE254R014	14	37.08	26.92	15.24
CHE254R016	16	39.62	29.46	17.78
CHE254R020	20	44.70	34.54	22.86
CHE254R024	24	49.78	39.62	27.94
CHE254R026	26	52.32	42.16	30.48
CHE254R030	30	57.40	47.24	35.56
CHE254R034	34	62.48	52.32	40.64
CHE254R040	40	70.10	59.94	48.26
CHE254R050	50	82.80	72.64	60.96



DESCRIPTION(內容):
**2.54mm Box Header Ejector Type
 PCB Mount Right Angle With Latch
 (RoHS)**
 PART NO:
 (料號) **CHE254R0XX**
 DWG NO(圖號): **HD2206012**

DRAWN(製圖):
 GONG
 CHECKED(確認):
 TERESA
 APPROVAL(核准):
 JOHNNY

GENERAL TOLERANCE:
 (公差)
 0.0 ±0.30
 0.00 ±0.20
 SCALE(比例):
 FREE

REV:	REV	DESCRIPTION	DATE
R3			
UNIT:	R0	環保料	2006.07.04
mm	R1	變更環保章字樣	2006.08.11
SIZE:	R2	修改圖示	2007.05.16
A4	R3	修正(A)尺寸	2016.03.23
SHEET:			
1/1			