

A B C D E

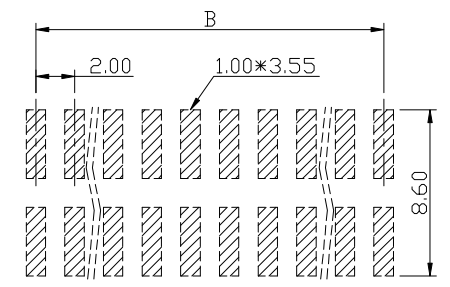

PCB Layout
(Top View)

MATERIAL AND FINISH
 Housing: Nylon-6T (UL94V-0), Black.
 Terminal: Brass, Gold Plating.

ELECTRICAL CHARACTERISTICS
 Current Rating: 1.0 Amp. Max..
 Dielectric Withstand Voltage:
 800V AC RMS for 60Seconds.
 Insulation Resistance:
 1000M Ohms Min. at 500V DC.

MECHANICAL CHARACTERISTICS
 Operating Temperature: -55°C ~ +105°C.

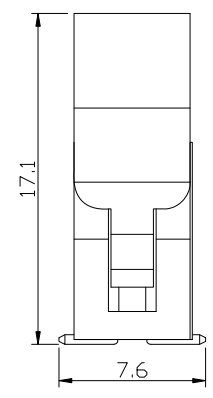
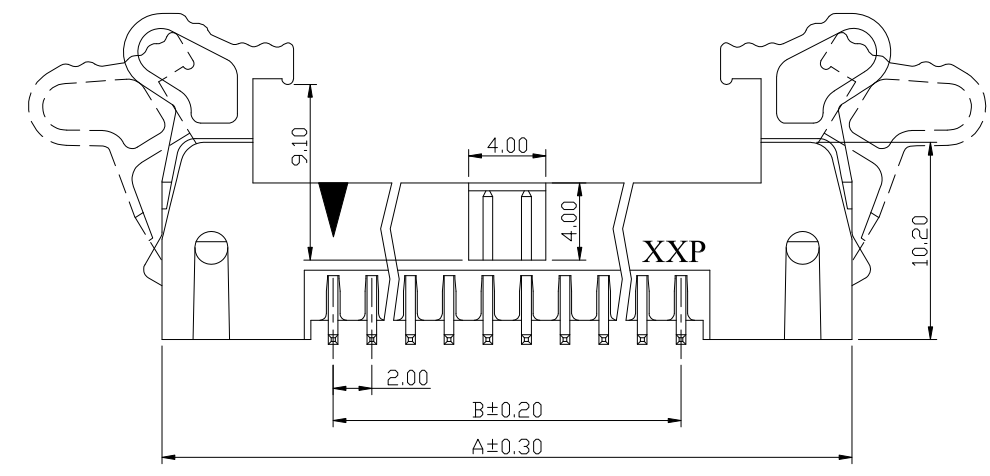
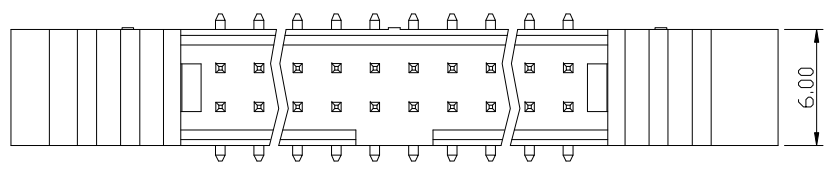

PART NO.	Dimensions	
	A	B
CHE200010S	25.70	8.00
CHE200012S	27.70	10.00
CHE200014S	29.70	12.00
CHE200016S	31.70	14.00
CHE200020S	35.70	18.00
CHE200022S	37.70	20.00
CHE200024S	39.70	22.00
CHE200026S	41.70	24.00
CHE200030S	45.70	28.00
CHE200034S	49.70	32.00
CHE200040S	55.70	38.00
CHE200044S	59.70	42.00
CHE200050S	65.70	48.00



DESCRIPTION(內容): 2.00mm Box Header Ejector PCB Surface Mount Type with Short Latch (RoHS)	DRAWN(製圖):	GENERAL TOLERANCE: (公差) .X ±0.3 .XX ±0.2 .XXX ±0.1	REV:	REV R0 R1 R2 R3	DESCRIPTION RELEASE 變更環保章字樣 變更Dim A尺寸 NEW RELEASE 60.64.68Pin 停產 變更塑料:NY9T→NY6T, 圖面更新, 變更圖號	DATE 2006.07.04 2006.08.11 2007.05.15 2009.07.17 2011.03.28 2013.05.14	
	CHECKED(確認):		UNIT:				
	PART NO: (料號)	APPROVAL(核准):	SCALE(比例):				SHEET:
	DWG NO(圖號):	JOHNNY	FREE				1/1

A B C D E