

SPECIFICATION:

1. VOLTAGE RATING: 20V & 3A
2. CONTACT RESISTANCE :50m Ω (MAX)
3. INSULATION RESISTANCE :100MΩ MIN, DC250V
4. OPERATION TEMPERATURE: -25°C~90°C
5. WITHSTAND VOLTAGE:500VAC
6. INSERTION FORCE :3-30N
7. EXTRACTION FORCE :3-30N
8. LIFE TESTING:5000 CYCLES
9. SOLDERING PROCES:PARTS WILL WITHSTAND 260°C/5SEC

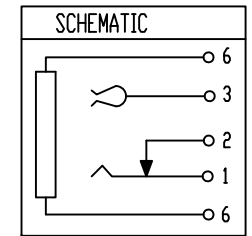

NO.	DESCRIPTION	QTY	MATERIAL	COLOR	REMARK
7	HOUSING	1	LCP(無鹵)	—	UL-94V0
6	SHELL 2	1	C2680	—	Ni PLATING(80-120u'')
5	SHELL 1	1	SUS301	—	—
4	TERMINAL 4	1	C2680	—	Tin PLATING(80-120u'')
3	TERMINAL 3	1	C2680	—	Tin PLATING(80-120u'')
2	TERMINAL 2	1	C2680	—	Tin PLATING(80-120u'')
1	TERMINAL 1	1	C5191 EH	—	Tin PLATING(80-120u'')

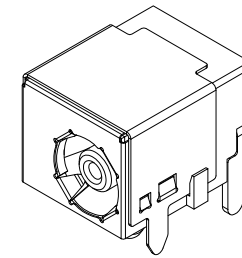
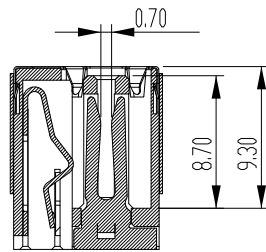
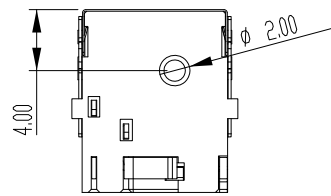
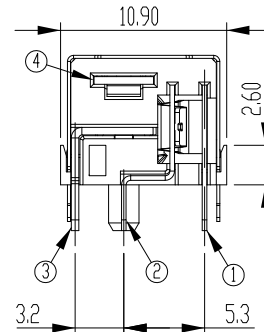
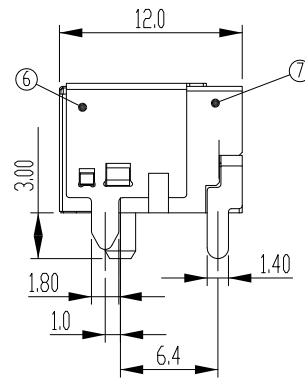
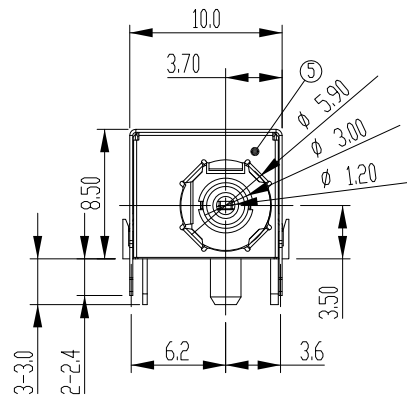

SECTION

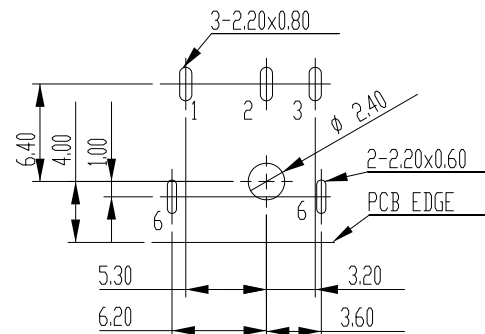

T=1.60mm Dimensions of PC board holes  
Top View Tolerance : ±0.05mm