

1. MATERIAL:
  - 1.1 HOUSING :PBT+G.F30%,UL94V-0, BLACK
  - 1.2 CONTACT: COPPER ALLOY
  - 1.3 SHELL: SPCC
2. FINISH:
  - 2.1 SHELL: NICKEL PLATED 30u" Min.
  - 2.2 CONTACT: GOLD PLATED IN CONTACT AREA 0.6u" Min, TIN PLATED IN SOLDER AREA 80u" Min. and 30u" Min NICKEL UNDER PLATED ALL OVER.
  - 2.3 BOARD LOCK: TIN PLATED 80u" Min.
  - 2.4 SQUARE RIVET: NICKEL PLATED 30u" Min.
  - 2.5 SHELL BRACKET:NICKEL PLATED 30u" Min.
3. ELECTRICAL CHARACTERISTICS:
  - 3.1 RATED CURRENT: 5 AMP MAX
  - 3.2 RATED VOLTAGE: 300V DC
  - 3.3 INSULATION RESISTANCE:1000M OHMS MIN.AT 500V
  - 3.4 CONTACT RESISTANCE: 30m OHMS MAX.
  - 3.5 DIELECTRIC WITHSTANDING VOLTAGE: 1000V AC FOR ONE MINUTE
  - 3.6 OPERATING TEMPERATURE: -55°C TO +105°C

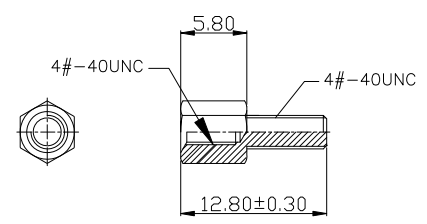
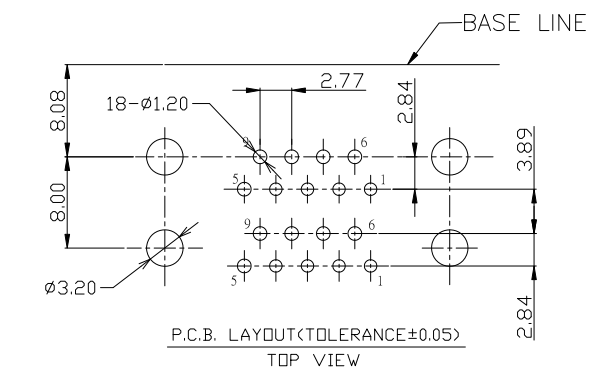
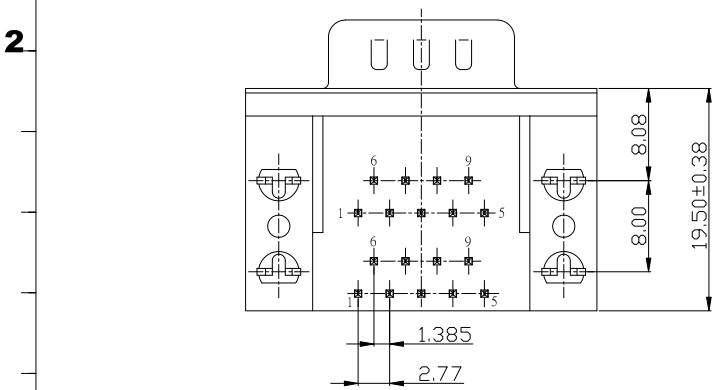

 承洧科技股份有限公司  
Chereng Wee Technology Corp.

DESCRIPTION(內容):  
9P公雙層叉鉚半金黑 19.05 (RoHS)

PART NO:  
(料 號) CDBR09MUB-09MUB6

DWG NO(圖號): AA20+9191-4208L4

DRAWN(製圖):  
GONG

CHECKED(確認):  
TERESA

APPROVAL(核准):  
JOHNNY

GENERAL TOLERANCE:  
(公差)

|      |      |
|------|------|
| .0   | ±.38 |
| .00  | ±.25 |
| .000 | ±.15 |

SCALE(比例):  
FREE

| REV:   | REV | DESCRIPTION                                       | DATE       |
|--------|-----|---|------------|
| R2     | R0  |   | 2018.01.26 |
| UNIT:  | R1  | 變更RATED CURRENT(原:3 AMP)&工作溫度(原:-45°C TO +85°C)   | 2018.01.31 |
| mm     | R2  | 變更RATED VOLTAGE(原:30V DC)&工作溫度(原:-45°C TO +105°C) | 2018.02.01 |
| SIZE:  | R3  |   |            |
| A4     |     |   |            |
| SHEET: |     |   |            |
| 1/1    |     |   |            |