

A

B

C

D

E

02P,03P

04P~06P

07P~15P

SPECIFICATIONS

Current Rating: 3A AC, DC

Voltage Rating: 500V AC, DC

Temperature Range: -25° C ~ +85° C

Contact Resistance: 20mΩ Max

Insulation Resistance: 100MΩ Min

Withstanding Voltage: 1500V AC/minute

Material: Nylon 66, UL94V-0

Pantone Color: 153C

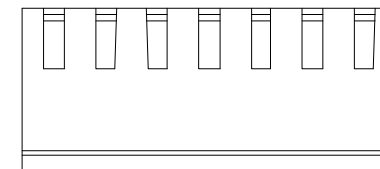
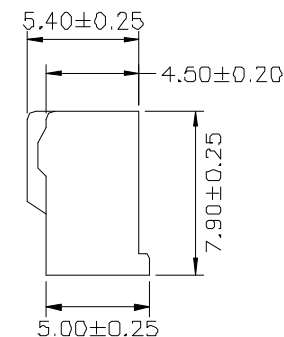
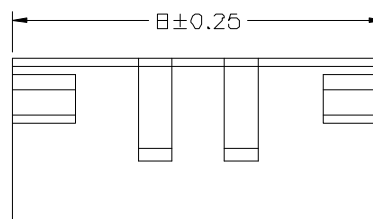
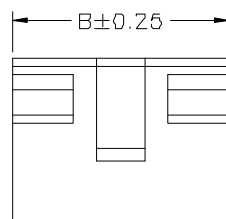
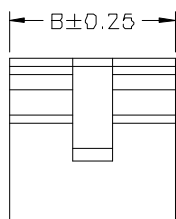
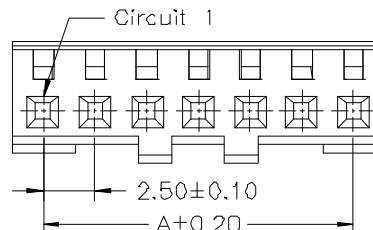
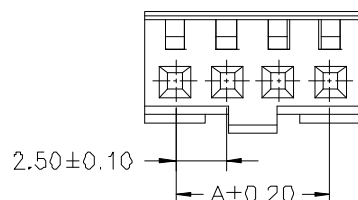
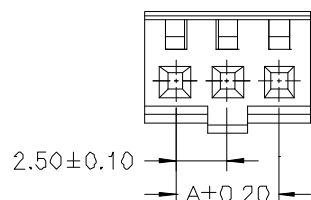

Ordering Information & Dimensions

PART NO.	Dimensions		PART NO.	Dimensions		PART NO.	Dimensions	
	A	B		A	B		A	B
CAE-H2501-02	2.50	5.50	CAE-H2501-07	15.00	18.00	CAE-H2501-12	27.50	30.50
CAE-H2501-03	5.00	8.00	CAE-H2501-08	17.50	20.50	CAE-H2501-13	30.00	33.00
CAE-H2501-04	7.50	10.50	CAE-H2501-09	20.00	23.00	CAE-H2501-14	32.50	35.50
CAE-H2501-05	10.00	13.00	CAE-H2501-10	22.50	25.50	CAE-H2501-15	35.00	38.00
CAE-H2501-06	12.50	15.50	CAE-H2501-11	25.00	28.00			



A

B

C

D

E